

FEATURES

- Flush fitment in pipeline
- Laser welded flush diaphragm
- Optional flushing ring
- Optional exotic materials

APPLICATION

- Slurry applications
- Transmitter refurbishment

Pan-cake



STANDARD SPECIFICATIONS

Range type	: -1 ... 250 bar
Wafer material	: AISI 316 SS
Diaphragm	: AISI 316L SS
Instrument connection	: 1/4" NPT (M)
Sealing fluid	: Silicon DC 710 [7°C to 371°C]
Process connection	: RF size as per ANSI B16.5 / EN 1092-1 / JIS B 2210
Assembly	: Remote
Capillary	: AISI 304 SS
Armour	: AISI 304 SS
Remote mounting length	: 2000 mm

DIMENSIONAL DRAWING

Type S48

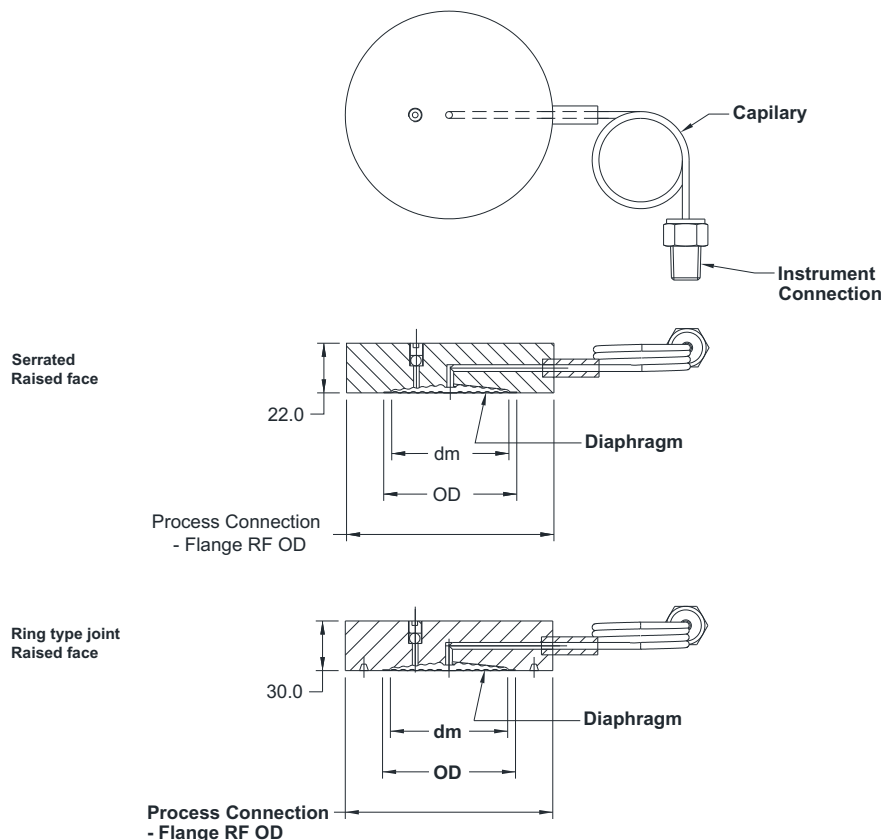

ORDERING CODES

1. RANGE TYPE	S42	7. PROTECTION ON WETTED PARTS	XX
S42 -1...250 bar		PC PTFE coating on diaphragm or wetted parts	
		PB PTFE protection from diaphragm	
2. CHAMBER MATERIAL	LF	8. ASSEMBLY	B9
LF AISI 316 SS		B9 Remote (capillary)	
LG AISI 316L SS			
LM Monel 400			
LO Hastelloy C-276			
3. DIAPHRAGM MATERIAL	DG	9. CAPILLARY	OU
DG AISI 316L SS		OU AISI 304 SS	
DM Monel 400		OV AISI 316 SS	
DO Hastelloy C-276			
DV Titanium			
DW Tantalum			
DX Nickel			
4. INSTRUMENT CONNECTION	12N	10. ARMOUR	OX
12B 1/4" BSP (M)		OX AISI 304 SS	
12N 1/4" NPT (M)		OY AISI 316 SS	
14B 1/2" BSP (M)		OZ PVC (Ambient max. 60°C)	
14N 1/2" NPT (M)			
5. SEALING FLUID	OL	11. REMOTE MOUNTING LENGTH	2000
OI Syltherm 800 [-40°C to 315°C]		XXXX 2000 mm up to 6000 mm	
OL Silicon DC 710 [7°C to 371°C]			
OA Silicon DC 200 [-40°C to 205°C]			
6. PROCESS CONNECTION	T92	12. OTHER OPTIONS	XX
T91 1 1/2" RF flange connection		XZ Dry seal	
T92 2" RF flange connection		HL Helium leak test	
T93 3" RF flange connection		TM Material test certificate 2.2	
T94 4" RF flange connection		TC Material test certificate 3.1	
T95 5" RF flange connection			

Ordering Example : D402-S42-LF-DG-04N-OL-T92-XX-B9-OU-OX-2000

MOUNTING KITS

Hardware	Bolt/ Nut/ Washer
Flanges	Suitable mating type
Gaskets	Metal / Graphoil

NOTES:

- Other sealing liquids are available, contact factory for further details.
- All metal diaphragms are laser welded to the Top Chamber.